

Materiale	Poliammide, fibra di vetro rinforzata
Guarnizione	NBR
Materiale o-ring	NBR
Protezione	IP 68 – 10 bar
Livello protezione ATEX	II 2G Ex eb IIC Gb / II 1D Ex ta IIIC Da / Class I Div 2 Groups A,B,C,D / Class II Div 1 Groups E,F,G
Temperatura di impiego	da -20°C a +85°C
Colore	nero / blu e nero
RAL	9005 / 5012



lungo

PER LA DISPONIBILITA' DI MAGAZZINO VEDERE A PAGINA 3

AG	∅k mm	H mm	SW1/SW2 mm	⊕ Nm	GL mm	Art. nero corto	Art. blu e nero corto	GL mm	Art. nero	Art. blu e nero
M12 x 1,5	2-5	21	15/15	2	8	1.292.1201.51	1.292.1202.51	15	1.292.1201.31	1.292.1202.31
M12 x 1,5	3-6,5	21	15/15	1,5	8	1.292.1201.50	1.292.1202.50	15	1.292.1201.30	1.292.1202.30
M16 x 1,5	3-6	22	19/19	2	8	1.292.1601.51	1.292.1602.51	15	1.292.1601.31	1.292.1602.31
M16 x 1,5	3-7	25	22/22	3	8	1.292.1611.51	1.292.1612.51	15	1.292.1611.31	1.292.1612.31
M16 x 1,5	4-8	22	19/19	2	8	1.292.1601.50	1.292.1602.50	15	1.292.1601.30	1.292.1602.30
M16 x 1,5	5-10	25	22/22	3	8	1.292.1611.50	1.292.1612.50	15	1.292.1611.30	1.292.1612.30
M20 x 1,5	5-9	27	24/24	4,5	9	1.292.2001.51	1.292.2002.51	15	1.292.2001.31	1.292.2002.31
M20 x 1,5	6-12	27	24/24	4,5	9	1.292.2001.50	1.292.2002.50	15	1.292.2001.30	1.292.2002.30
M20 x 1,5	7-12	28	27/27	4,5	9	1.292.2016.51	1.292.2017.51	15	1.292.2016.31	1.292.2017.31
M20 x 1,5	10-14	28	27/27	4,5	9	1.292.2016.50	1.292.2017.50	15	1.292.2016.30	1.292.2017.30
M25 x 1,5	9-16	31	33/33	5	11	1.292.2501.51	1.292.2502.51	15	1.292.2501.31	1.292.2502.31
M25 x 1,5	13-18	31	33/33	5	11	1.292.2501.50	1.292.2502.50	15	1.292.2501.30	1.292.2502.30
M32 x 1,5	13-20	39	42/42	6,5	11	1.292.3201.51	1.292.3202.51	15	1.292.3201.31	1.292.3202.31
M32 x 1,5	18-25	39	42/42	6,5	11	1.292.3201.50	1.292.3202.50	15	1.292.3201.30	1.292.3202.30
M40 x 1,5	20-26	48	53/53	10	13	1.292.4001.51	1.292.4002.51	18	1.292.4001.31	1.292.4002.31
M40 x 1,5	22-32	48	53/53	10	13	1.292.4001.50	1.292.4002.50	18	1.292.4001.30	1.292.4002.30
M50 x 1,5	25-31	49	60/60	15	13	1.292.5001.51	1.292.5002.51	18	1.292.5001.31	1.292.5002.31
M50 x 1,5	32-38	49	60/60	15	13	1.292.5001.50	1.292.5002.50	18	1.292.5001.30	1.292.5002.30
M63 x 1,5	29-35	49	65/68	22	14	1.292.6301.51	1.292.6302.51	18	1.292.6301.31	1.292.6302.31
M63 x 1,5	37-44	49	65/68	22	14	1.292.6301.50	1.292.6302.50	18	1.292.6301.30	1.292.6302.30

DISTRIBUITO DA- DISTRIBUTED BY



GCE SRL



MILANO - ITALY

www.antideflagranti.com

comm@antideflagranti.com



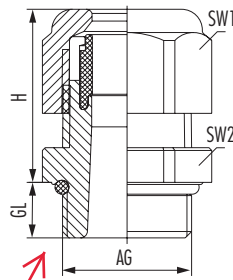

FILETTO LUNGO

Materiale	Poliammide, fibra di vetro rinforzata
Guarnizione	NBR
Materiale o-ring	NBR
Protezione	IP 68 – 10 bar
Livello protezione ATEX	II 2G Ex eb IIC Gb / II 1D Ex ta IIIC Da / Class I Div 2 Groups A,B,C,D / Class II Div 1 Groups E,F,G
Temperatura di impiego	da -20°C a +85°C
Colore	nero / blu e nero
RAL	9005 / 5012

RoHS

PER LA DISPONIBILITA' DI MAGAZZINO VEDERE A PAGINA 3

AG	∅k mm	GL mm	H mm	SW1/SW2 mm	⊕ Nm	Art. nero	Art. lungo	Art. blu e nero	Art. lungo
NPT 3/8"	3 – 6	15	22	19/22	2	1.292.3801.71		1.292.3802.71	
NPT 3/8"	4 – 8	15	22	19/22	2	1.292.3801.70		1.292.3802.70	
NPT 1/2"	5 – 9	13	27	24/24	4,5	1.292.1201.71		1.292.1202.71	
NPT 1/2"	6 – 12	13	27	24/24	4,5	1.292.1201.70		1.292.1202.70	
NPT 1/2"	7 – 12	13	28	27/27	4,5	1.292.1216.71		1.292.1217.71	
NPT 1/2"	10 – 14	13	28	27/27	4,5	1.292.1216.70		1.292.1217.70	
NPT 3/4"	9 – 16	14	31	33/33	5	1.292.3401.71		1.292.3402.71	
NPT 3/4"	13 – 18	14	31	33/33	5	1.292.3401.70		1.292.3402.70	
NPT 1"	13 – 20	19	39	42/42	6,5	1.292.1001.71		1.292.1002.71	
NPT 1"	18 – 25	19	39	42/42	6,5	1.292.1001.70		1.292.1002.70	
NPT 1 1/4"	13 – 20	16	39	42/46	6,5	1.292.5401.71		1.292.5402.71	
NPT 1 1/4"	18 – 25	16	39	42/46	6,5	1.292.5401.70		1.292.5402.70	
NPT 1 1/2"	20 – 26	20	48	53/53	10	1.292.6401.71		1.292.6402.71	
NPT 1 1/2"	22 – 32	20	48	53/53	10	1.292.6401.70		1.292.6402.70	

DISTRIBUITO DA- DISTRIBUTED BY



GCE SRL



MILANO - ITALY

www.antideflagranti.com

comm@antideflagranti.com

HSK-K-Ex-Active UNI..XE HN

DISTRIBUITO DA- DISTRIBUTED BY



GCE SRL



MILANO - ITALY

www.antideflagranti.com

Technical information	
Material	Polyamid
Formdichtung / O-Ring	NBR / NBR
Schutzart	IP 68 – 10 bar im angegebenen Klemmbereich
Dauergebrauchstemperatur	-20°C bis +85°C
Lieferfarbe	schwarz NERO BLACK

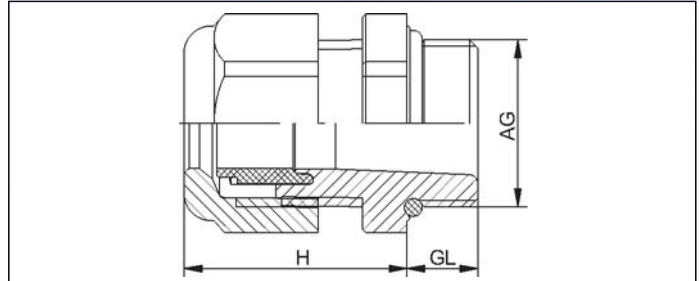

CODICE INTERNO

UNI 02XE-HM [*]	M 12 x 1,5	3 – 6,5	8	21	15	1.292.1201.50
UNI 01XE-HM [*]	M 16 x 1,5	4 – 8	8	22	19	1.292.1601.50
UNI 01XE-HM [*]	M 16 x 1,5	3 – 6	8	22	19	1.292.1601.51
UNI 01XE-HM [*]	M 16 x 1,5	5 – 10	8	25	22	1.292.1601.50
UNI 01XE-HM [*]	M 16 x 1,5	3 – 7	8	25	22	1.292.1611.50
UNI 1XE-HM [*]	M 20 x 1,5	6,5 – 12	9	27	24	1.292.2001.50
UNI 1XE-HM [*]	M 20 x 1,5	5 – 9	9	27	24	1.292.2001.51
UNI 1XE-HM [*]	M 20 x 1,5	10 – 14	9	28	27	1.292.2001.50
UNI 1XE-HM [*]	M 20 x 1,5	7 – 12	9	28	27	1.292.2016.50
UNI 2XE-HM [*]	M 25 x 1,5	13 – 18	11	31	33	1.292.2501.50
UNI 2XE-HM [*]	M 25 x 1,5	9 – 16	11	31	33	1.292.2501.51
UNI 3XE-HM [*]	M 32 x 1,5	18 – 25	11	39	42	1.292.3201.50
UNI 3XE-HM [*]	M 32 x 1,5	13 – 20	11	39	42	1.292.3201.51
UNI 4XE-HM [*]	M 40 x 1,5	22 – 32	13	48	53	1.292.4001.50
UNI 4XE-HM [*]	M 40 x 1,5	20 – 26	13	48	53	1.292.4001.51
UNI 5XE-HM [*]	M 50 x 1,5	32 – 38	13	49	60	1.292.5001.50
UNI 5XE-HM [*]	M 50 x 1,5	25 – 31	13	49	60	1.292.5001.51
UNI 6XE-HM [*]	M 63 x 1,5	37 – 44	14	49	65 / 68	1.292.6301.50
UNI 6XE-HM [*]	M 63 x 1,5	29 – 35	14	49	65 / 68	1.292.6301.51

LA FILETTATURA NPT NON E' GESTITA
A MAGAZZINO, MA DISPONIBILE SU
ORDINAZIONE

NPT 3/8"	4 – 8	15	22	19 / 22	1.292.3802.70
NPT 3/8"	2 – 6	15	22	19 / 22	1.292.3802.71
NPT 1/2"	6,5 – 12	13	27	24	1.292.1202.70
NPT 1/2"	5 – 9	13	27	24	1.292.1202.71
NPT 1/2" (16)	10 – 14	13	28	27	1.292.1218.70
NPT 1/2" (16)	7 – 12	13	28	27	1.292.1218.71
NPT 3/4"	13 – 18	14	31	33	1.292.3402.70
NPT 3/4"	9 – 16	14	31	33	1.292.3402.71
NPT 1"	18 – 25	19	39	42	1.292.1002.70
NPT 1"	13 – 20	19	39	42	1.292.1002.71
NPT 1 1/4"	18 – 25	16	39	42 / 46	1.292.5402.70
NPT 1 1/4"	13 – 20	16	39	42 / 46	1.292.5402.71
NPT 1 1/2"	22 – 32	20	48	53	1.292.6402.70
NPT 1 1/2"	20 – 26	20	48	53	1.292.6402.71

[*] ARTICOLI NON GESTITI A MAGAZZINO DISPONIBILI SOLO SU ORDINAZIONE

